

WP-17/WP-17V

AIR-COOLED Patented

Hand-Held Torches

11/2007 WP-4.0



- 150 amp DC, 125 amp AC at 60% duty cycle
- Electrode range: 0.020" – 1/8" (0.5 – 3.2 mm)

WP-17



6.1 oz
(172 g)

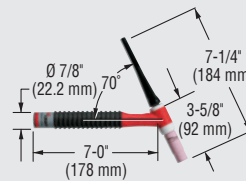

WP-17V



6.8 oz
(193 g)

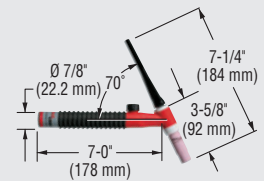

The versatile air-cooled solution designed for maximum operator comfort!



WP-17

"WP" Series TIG torches

These innovative torches feature a resilient, high-temperature silicone rubber insulation that prevents leakage of high-frequency voltage, a common occurrence of phenolic insulation. They have earned the respect of the most demanding industries around the world in meeting their welding torch needs day in and day out.

Eliminate the complexity of using a water-cooled system. These air-cooled torches are a cost-effective alternative that work well for field applications.

Ribbed handle and torch design provide cool operation and maximum operator comfort while reducing downtime caused by operator fatigue.

Compact and durable design is ideal for both the professional and hobbyist welder.

Available with 12-1/2 or 25 ft, single- or heavy-duty two-piece cable assembly determined by the compatibility of the power source. Heavy-duty cable assembly allows use of a larger conductor for the power cable which simplifies repair and replacement making it ideal for field applications.

Patented Diamond Grip™ head design has ergonomic contact points for thumb and fingers. Provides a more comfortable grip and reduces operator fatigue.



WP-17V

Compatible with all 10N Series consumables.

Utilize existing parts. Replacement parts are the same as the WP-18 and WP-26 torch models. Standard Weldcraft front-end parts... your assurance of maximum performance.

Available gas control valve. Allows operator quick and easy control of shielding gas flow.

Teflon® insulators for the nozzle and back cap ensure a positive seal against both gas and high-frequency current leakage.

Quik Find Guide Torch Packages

• WP-17V-25-R	25' (7.6 m)
• WP-17V-25-2	25' (7.6 m)
• WP-17-25-R	25' (7.6 m)
• WP-17-25-2	25' (7.6 m)

WELDCRAFT
2741 N. Roemer Road
Appleton, WI 54911 USA

Weldcraft.com

Phone: 1.920.882.6800
Toll-free: 1.800.752.7620 (USA only)
Fax: 1.920.882.6840
E-mail: customerservice@weldcraft.com

WELD The TIG Welder's Choice
CRAFT

WP-17/WP-17V

It is recommended that this torch be used with original Weldcraft® power cables only. Use of non-Weldcraft power cables will void the warranty and may result in low performance or failure of the torch.

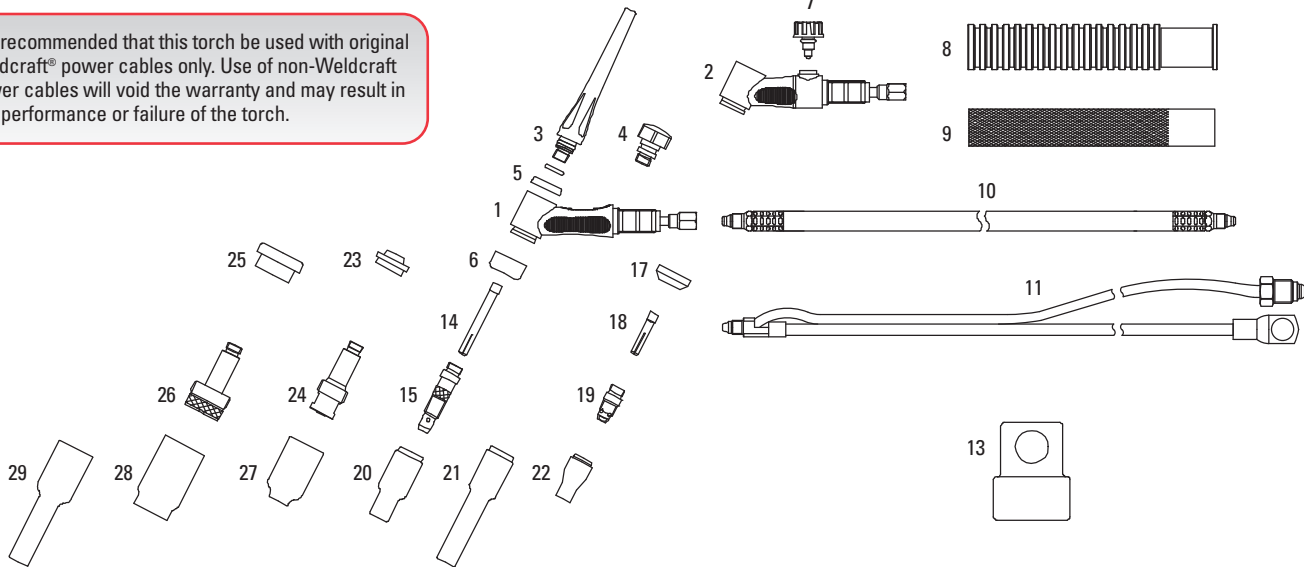

Parts Listing

Item #	Description	Part #
1	Torch Body (70°) (includes Insulators)	WP-17
2	Torch Body (70°) with Valve (includes Insulators)	WP-17V
3	Long Back Cap (includes 98W18 O-ring)	57Y02
4	Short Back Cap (includes 98W18 O-ring)	57Y04
5	Back Cap Insulator	18-7
6	Nozzle Insulator	18CG
7	Valve Stem (includes 98W77 O-ring)	VS-2
8	Ribbed Handle	H-100R
9	Knurled Handle	H-100
10	Power Cable — 12-1/2' (3.8 m) Rubber	57Y01R
	Power Cable — 25' (7.6 m) Rubber	57Y03R
11	Power Cable — 2-pc. 12-1/2' (3.8 m) Rubber Gas Hose only — 12-1/2' (3.8 m) Braided	57Y01-2 45V09R
	Power Cable — 2-pc. 25' (7.6 m) Rubber Gas Hose only — 25' (7.6 m) Braided	57Y03-2 45V10R
12	Slide Valve	V-92
13	Power Cable Adapter	105Z57

Accessories

Description	Part #
Accessory Kit — (1) short back cap (3) collets and collet bodies 0.040" 1/16", 3/32" (3) alumina nozzles #4, #5, #6 (3) 7" 2%-thoriated tungsten 0.040" 1/16", 3/32"	AK-2
Cable Cover — 10' (3 m)	WC-3-10
Cable Cover — 22' (6.7 m)	WC-3-22
Qwik Connector — 400A, 50 mm	Q5
Qwik Connector — 150A, 50 mm, w/Hose	Q5G-150
Qwik Connector — 150A, 50 mm, Flow Thru	Q5GT-150
Extension Kit	EK-2-25-R

Non-Gas Lens Set-Up

Item #	Description	Electrode Diameter — inch (mm)							
		.020 (0.5)	.040 (1.0)	1/16 (1.6)	3/32 (2.4)	1/8 (3.2)	5/32 (4.0)		
14	Collet	10N21	10N22	10N23	10N24	10N25	—		
15	Collet Body	10N29	10N30	10N31	10N32	10N28	—		
17	Stub. Nozzle Insul.	18CG20	18CG20	18CG20	18CG20	18CG20	—		
18	Stubby Collet	—	10N22S	10N23S	10N24S	10N25S	—		
19	Stubby Collet Body	—	17CB20	17CB20	17CB20	17CB20	—		
Item #	Description	Nozzle Size — size # (inch)							
		4 (1/4)	5 (5/16)	6 (3/8)	7 (7/16)	8 (1/2)	10 (5/8)	12 (3/4)	Short
20	Alumina	10N50	10N49	10N48	10N47	10N46	10N45	10N44	—
	Lava	105Z43	105Z42	105Z44	105Z45	08N78	08N79	08N80	—
21	Long Alumina	—	10N49L	10N48L	10N47L	—	—	—	—
	Long Lava	12N03	105Z60	12N02	105Z61	—	—	—	—
22	Stubby Alumina	13N08	13N09	13N10	13N11	13N12	13N13	—	—

Gas Lens Set-Up

Item #	Description	Electrode Diameter — inch (mm)							
		.020 (0.5)	.040 (1.0)	1/16 (1.6)	3/32 (2.4)	1/8 (3.2)	5/32 (4.0)		
23	Gas Lens Insulator	54N01	54N01	54N01	54N01	54N01	—		
14	Collet	10N21	10N22	10N23	10N24	10N25	—		
24	Gas Lens	45V29	45V24	45V25	45V26	45V27	—		
25	Lg. Dia. Gas Lens Insulator	54N63	54N63	54N63	54N63	54N63	—		
14	Collet	10N21	10N22	10N23	10N24	10N25	—		
26	Lg. Dia. Gas Lens	45V0204	45V0204	45V116	45V64	995795	—		
Item #	Description	Nozzle Size — size # (inch)							
		4 (1/4)	5 (5/16)	6 (3/8)	7 (7/16)	8 (1/2)	10 (5/8)	12 (3/4)	Short
27	Alumina GL	54N18	54N17	54N16	54N15	54N14	—	—	54N19 ¹
29	Long Alumina GL	—	54N17L	54N16L	54N15L	—	—	—	—
28	Alumina Lg. Dia. GL	—	—	57N75	—	57N74	53N88	53N87	54N89 ¹
29	Long Alumina Large Diameter GL	—	—	57N75L	—	57N74L	53N88L	53N87L	—
29	X-Long Alumina Large Diameter GL	—	—	57N75 XL	—	57N74 XL	53N88 XL	53N87 XL	—
29	XX-Long Alumina Large Diameter GL	—	—	57N75 XXL	—	57N74 XXL	53N88 XXL	53N87 XXL	—

NOTES:
1. Not recommended for use with high-frequency current.

