

CS310 & CS410 310 & 410 AMP WATER-COOLED TORCHES

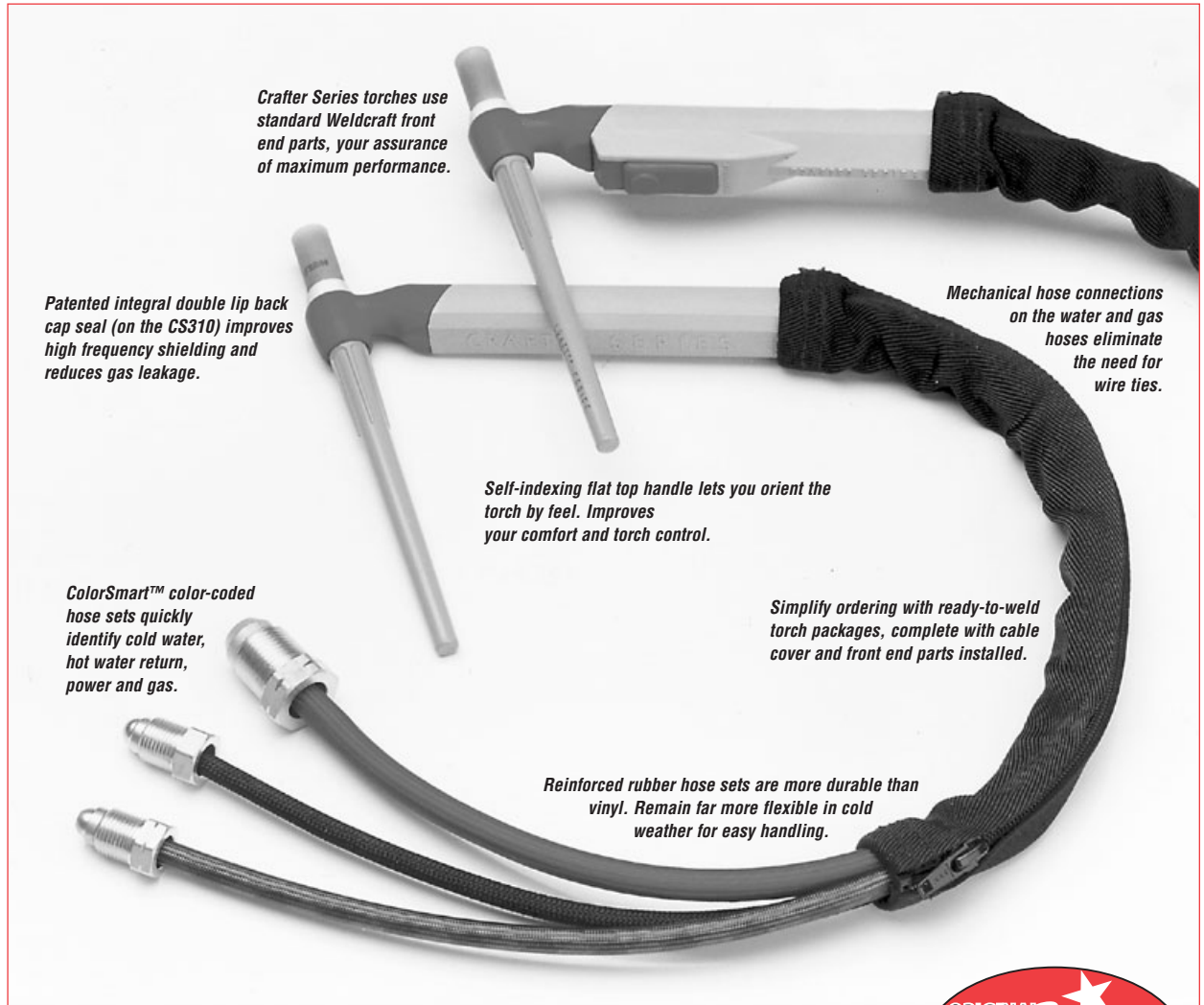

Crafter Series torches use standard Weldcraft front end parts, your assurance of maximum performance.

Patented integral double lip back cap seal (on the CS310) improves high frequency shielding and reduces gas leakage.

Mechanical hose connections on the water and gas hoses eliminate the need for wire ties.

Self-indexing flat top handle lets you orient the torch by feel. Improves your comfort and torch control.

ColorSmart™ color-coded hose sets quickly identify cold water, hot water return, power and gas.

Simplify ordering with ready-to-weld torch packages, complete with cable cover and front end parts installed.

Reinforced rubber hose sets are more durable than vinyl. Remain far more flexible in cold weather for easy handling.



They make all other 18 and 20 style torches obsolete!

- The Crafter Series TIG torches are engineered for the professional TIG welder. So they're more than merely a step up. They're a quantum leap in TIG torch design, on every level. Our state-of-the-art CS310 and CS410 torches define a new standard in performance, reliability, and reduced cost of operation.

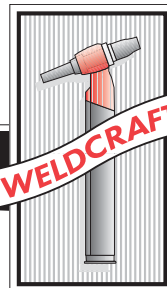

- Just compare the forty-year-old design of your water-cooled torches with the high performance, ready-to-weld Crafter Series. There is no comparison. Call 1-800-752-7620 or ask your local distributor for the Weldcraft Crafter Series...the TIG torches that hold the patent on the future.

Complete Torch Packages*

310 AMP Part No.	Description	410 AMP Part No.	Description
CS310-12	CS310 torch w/ 12' cable	CS410-12	CS410 torch w/ 12' cable
CS310-25	CS310 torch w/ 25' cable	CS410-25	CS410 torch w/ 25' cable

***CS310 torch packages come assembled with:**

Torch body, handle, gas & water hoses, power cable, #6 HPN nozzle, 3/32" collet, 3/32" collet body, 3/32" x 7" tungsten electrode, long back cap and cable cover.

***CS410 torch packages come assembled with:**

Torch body, handle, gas & water hoses, power cable, #8 HPN nozzle, 1/8" collet, 1/8" collet body, 1/8" x 7" tungsten electrode, long back cap and cable cover.

Accessories

CS310-UAK Universal Accessory Kit, contains the following:		CS410-UAK Universal Accessory Kit, contains the following:	
(1) each	3/32" and 1/8" collets	(1) each	1/8" and 5/32" collets
(1) each	3/32" and 1/8" collet bodies	(1) each	1/8" and 5/32" collet bodies
(1) each	3/32" and 1/8" gas lens collet bodies	(1) each	1/8" and 5/32" gas lens collet bodies
(1) each	3/32" x 7" and 1/8" x 7" tungsten electrodes	(1) each	1/8" x 7" and 5/32" x 7" tungsten electrodes
(1) each	short, medium and long back caps	(1) each	short and long back caps
(1) each	#5 and #6 alumina nozzles	(1) each	#7 and #8 alumina nozzles
(1) each	#5 and #6 gas lens alumina nozzles	(1) each	gas lens insulator
(1) each		(1) each	#7 and #8 gas lens alumina nozzles
HK-1 Hookup Kit, contains the following:		HK-1 Hookup Kit, contains the following:	
(1) each	Power Cable Adapter (45V11)	(1) each	Power Cable Adapter (45V11)
(2) each	Water Hoses, 12-1/2' (40V76)	(2) each	Water Hoses, 12-1/2' (40V76)
(1) each	Water Hose Coupler, (11N18)	(1) each	Water Hose Coupler, (11N18)
(2) each	Water Adapter Fittings, 1/4" NPT male to hose	(2) each	Water Adapter Fittings, 1/4" NPT male to hose
(1) each	Gas Hose, 12-1/2' (40V77)	(1) each	Gas Hose, 12-1/2' (40V77)
Q5W QCS Hookup Kit, solid DIN w/water side hose		Q5W QCS Hookup Kit, solid DIN w/water side hose	
Switch Parts**		Switch Parts**	
CS110-SH	small switch handle	CS210-SH	small switch handle
SH-BB-1	1-button switch w/out wire	SH-BB-1	1-button switch w/out wire
SH-BB-2	2-button switch w/out wire	SH-BB-2	2-button switch w/out wire
5830001-1	1-button switch with 15' wire	5830001-1	1-button switch with 15' wire
5830001-2	1-button switch with 27' wire	5830001-2	1-button switch with 27' wire
5830002-1	2-button switch with 15' wire	5830002-1	2-button switch with 15' wire
5830002-2	2-button switch with 27' wire	5830002-2	2-button switch with 27' wire
CSH-BC-1F	1-button switch boot cover	CSH-BC-1F	1-button switch boot cover
CSH-BC-2F	2-button switch boot cover	CSH-BC-2F	2-button switch boot cover

**Switches are low amperage momentary switches designed for digital controlling of specified machine options. They are not suitable for all machines. Machine terminals are not included.